

2 Megapixel 32x Low Lux IR PTZ Network Camera AA2912D-IR-32x

Premium



- SONY 1/2.8" 2.43MP Sony progressive scan CMOS sensor
- H.264 and MJPEG Dual-Stream simultaneously
- Full HD 1080P at 25/30 fps real time
- 32X Optical Zoom & Auto Focus
- Built-in 9 IR LEDs for 180M distance with smart IR
- Defog function
- Low illumination
- Outdoor use
- Open Standard Protocol

Camera	
Image Device	SONY 1/2.8" 2.3 Mega-pixel Sony progressive scan CMOS sensor
Effective Pixels	1920 x 1080 pixels
Lens	f4.5 ~ 144mm motorized lens
Optical Zoom	32X
Lens Adjustment	Auto/Manual Focus
IRIS	Fw1.6~Ft4.8
Field Angle	59.8°(w)~2.34°(t)
Min. Illumination	Color:0.05Lux @(F1.6,AGC ON),ICR ON Black:0.02 Lux @(F1.6,AGC ON),ICR OFF
Day & Night	TDN (Mechanical ICR)
Video	
Video Encoder	H.264 and MJPEG simultaneously
Frame Rate	25/30fps
Electronic shutter	1/10000s to 1/25s
Exposure Control	D-WDR BLC Auto/Manual exposure
Image Setting	<ul style="list-style-type: none"> ● Auto AWB/AGC/AE/AIC ● 3D Noise reduction ● Adjustable image format, brightness, sharpness, contrast, saturation ● Mirror/Flip ● Privacy Masks (4 area) ● Defog (optional)
Video Bit Rate	32Kpbs ~ 8Mbps adjustable
Audio	
Audio Encoder	RTSP: G.711 64kbps, AAC, MP2
Audio Streaming	two-way

Network	
Supported Protocols	IPv4, TCP/IP, UDP, HTTP, DHCP, RTP/RTCP, FTP, UPnP, DDNS, NTP, IGMP, ICMP
Security	password protection, multi user access
Ethernet	10/100M auto negotiation
System Integration	
Alarm Events	<ul style="list-style-type: none"> ● Capture ● Record ● Call PTZ Preset ● Cruise ● Uplond alarm to NVR ● Trigger alarm output
PTZ Function	
Horizontal Speed	0°~360°
Vertical Speed	0°~90°
Preset	256 points
Preset Cruise	8 (each of the 16 presets)
Pattern Path	8 (support 8 paths)
Watching Function	Support
General	
Power Supply	AC24V/3A,max 33W
Connectors	<ul style="list-style-type: none"> ● RJ-45 10Base-T/100Base-TX ● 24V AC power jack ● 2 alarm input and 1 output ● Line In/out ● 1.0V[p-p]/75Ω, BNC ● External SD card slot, support SD/SDHC
Operating Temperature	-20°C +60°C
Operating Humidity	0~90% RH(Non-condensing)
Dimension	Wall holder: Φ204.8 x H371.4 x W272.3mm Lifting holder: Φ204.8 x H594.1mm
Weight	4.5 Kg
Protection Grade	Outdoor use, 3000V Lightning storm surge protection

※ The product design and dimensions may change without previous notice for improvement of performance.

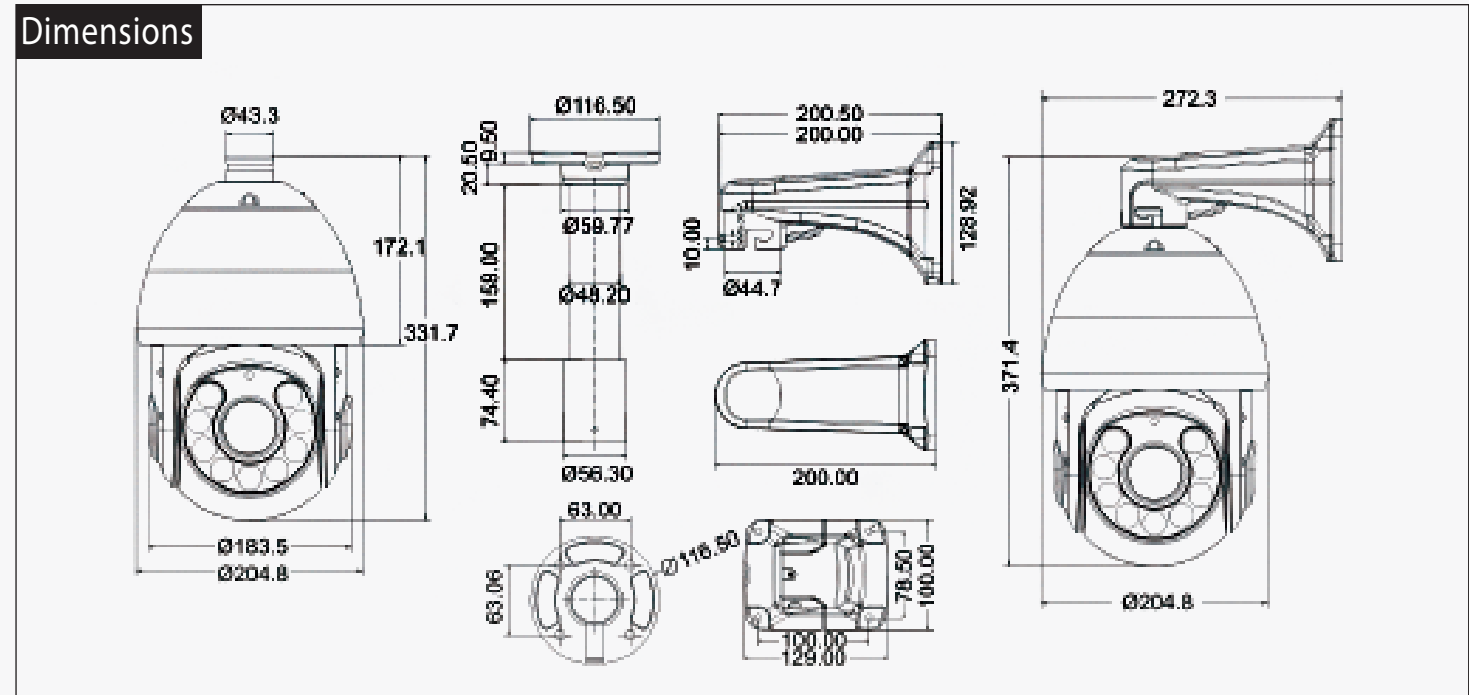

Distributed by :

